

Dry running seal
Balanced
Outside mounted
Independent of rotation
Massive seal rings

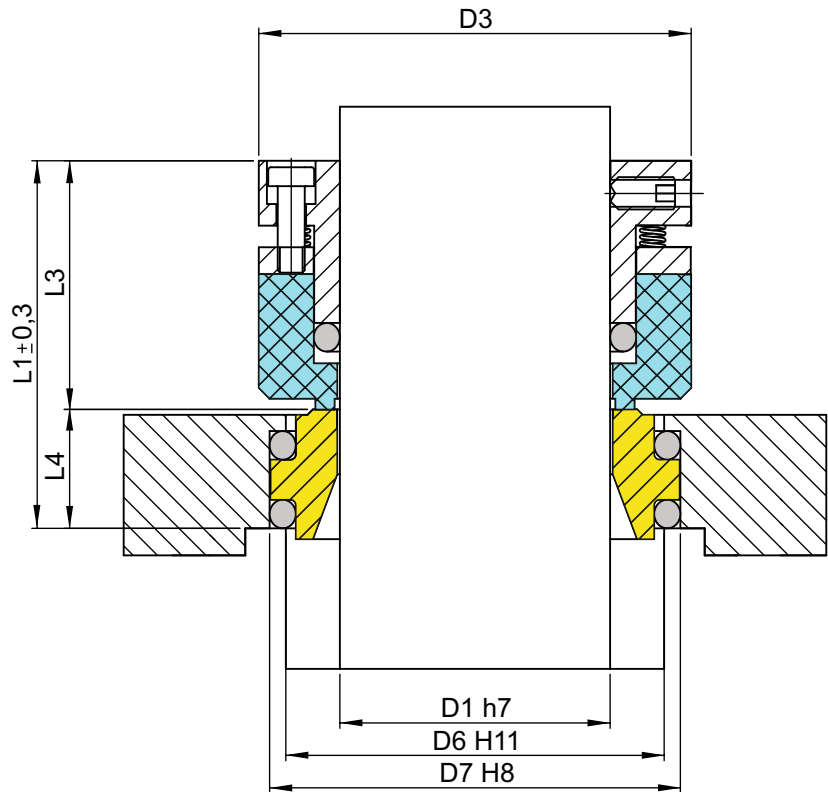

Materials:
 Rotary: T1, T2
 Stationary: Q1, V
 Rubber parts: P, E, V, K, M

Operating limits:
 (look at working conditions page 112)

$p \leq$ Vakuum	6bar
$t =$	$-20 \div 150^{\circ}\text{C}$ (250°C)
$v \leq$	1 m/s

D1	D6	D7	D3	L1	L3	L4
20	36	42	46	63	43	20
25	41	47	51	63	43	20
30	46	52	56	63	43	20
35	51	57	61	63	43	20
40	60	66	70	68	46	22
45	65	71	75	68	46	22
50	70	76	80	68	46	22
55	75	81	85	68	46	22
60	85	91	92	74	50	24
65	90	96	97	74	50	24
70	95	101	102	76	50	26
75	104	110	109	76	50	26
80	109	115	114	83	56	27
85	114	120	120	83	56	27
90	119	125	124	83	56	27
95	124	130	130	83	56	27
100	129	135	134	83	56	27
105	134	140	140	83	56	27
110	139	145	146	83	56	27
120	150	160	160	95	62	33
130	160	170	170	95	62	33
140	175	185	180	95	62	33
150	190	200	200	120	84	36
160	200	210	210	120	84	36
170	210	220	220	120	84	36
180	220	230	230	120	84	36